



Sealeys
Walker ■ Jarvis

(01474) 369368



Basement Office, 26 Harmer Street

Gravesend, Kent, DA12 2AX

£675 PCM



- Basement Office Measuring 385 Sq Ft
- Office 2: 179 Sq Ft
- Water Included
- Kitchenette
- Office 1: 112 Sq Ft
- Electric Included
- Situated on Gravesend's One-Way System
- WC

Full Description

RENT

£675 PER CALENDAR MONTH (£8,100 PER ANNUM)

Rent includes electricity, water, heating and building insurance

LOCATION DESCRIPTION

Located on the one-way system around Gravesend town centre is this modern and light basement office on the approach to the town's clock tower.

PROPERTY DESCRIPTION

Basement office comprising:

Office 1: 112 Sq Ft with French doors opening onto a small paved area.

Office 2: 179 Sq Ft

Kitchenette and WC

CURRENT BUSINESS RATES

The Valuation Office website shows a current rateable value of £2,550 per annum which normally means that between 40% to 50% of this figure is payable. Interested parties are advised to seek clarification from the local authority.

CURRENT CLASS OF BUSINESS USE

The current class of business use is an 'E' Category Use. Interested parties are advised to seek clarification of permitted use from the local authority.

AGENTS NOTE

Ingoing tenants to pay a referencing fee of £150 including VAT

Floor Plan

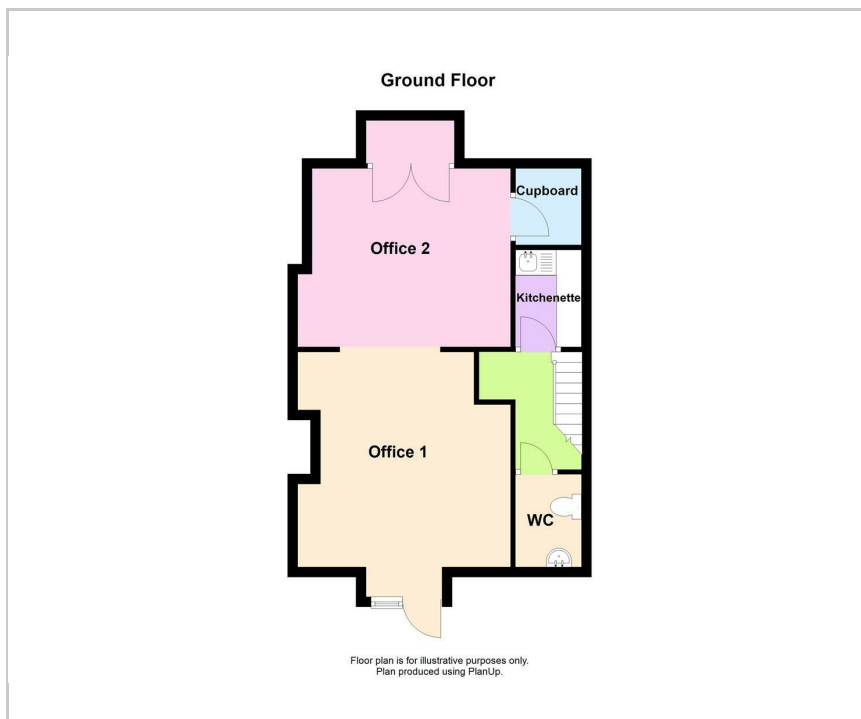

Energy Efficiency Graph

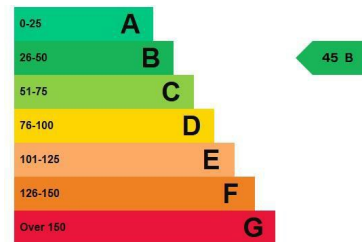

Viewing

Please call our Commercial Department on (01474) 369368 or Email: commercial@sealeys.co.uk if you would like to arrange a viewing for this property or require further information.

Sealeys Walker Jarvis
184 Parrock Street
Gravesend
Kent
DA12 1EN
www.sealeys.co.uk



Agents Note: Whilst every care has been taken to prepare these marketing particulars, they are for guidance purposes only. These details, description and measurements do not form part of a contract and whilst every effort has been made to ensure accuracy this cannot be guaranteed. Interested parties must satisfy themselves by inspection or otherwise as to the correctness of them. Floor plans are not to scale and are for illustration purposes only. Any equipment, fixtures and fittings or any item referred to have not been tested unless specifically stated.